

# 1003BC

(Polish production)

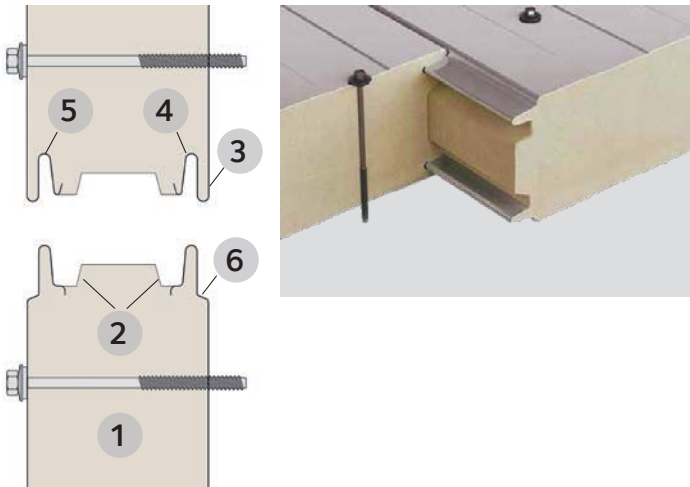

- 1 A core of rigid polyisocyanurate foam
- 2 Milled labyrinth joint eliminating thermal bridge
- 3 Profiled cladding sheets guarantee an aesthetic and functional appearance
- 4 Suitably shaped lock with easy seal installation
- 5 Seals to prevent penetration of air and water vapor (butyl seals applied during assembly)
- 6 Additional seal applied to the lock groove system (polyurethane seals applied during assembly)

Panel thc.	1003 BC	
	U value according to EN 14509	Panel weight
mm	W/m <sup>2</sup> K	kg/m <sup>2</sup>
120	0,20 (0,19)*	14,6
160	0,15 (0,14)*	15,0
200	0,12 (0,11)*	16,6

\* surface fixing with the help of the joint element with thermal bridge

1003 BC							
Fire resistance (wall) according to EN 13501-2 EN 1364-1 ČSN EN 73 0810	EI 15 DP3 (i→o)		EI 20 DP3 (i→o)		EI 30 DP3 (i→o)		Reaction to fire according to EN 13501-1 B-s2,d0
	Panel thc.	vert.	horiz.	vert.	horiz.	vert.	
120 mm	12,0 m	4,0 m	12,0 m	4,0 m	3,0 m	3,0 m	
160 mm	12,0 m	4,0 m	12,0 m	4,0 m	3,0 m	3,0 m	
200 mm	12,0 m	4,0 m	12,0 m	4,0 m	3,0 m	3,0 m	

Note: Spans have to be consulted.

## Standard colors:

Exterior (Hairplus 25):



Other colors available on request

# PIR COLDROOM PANEL

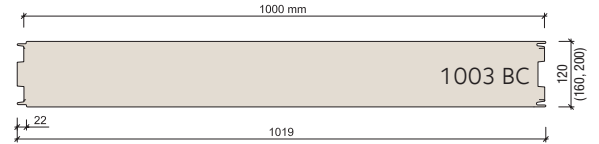

## PROFILING

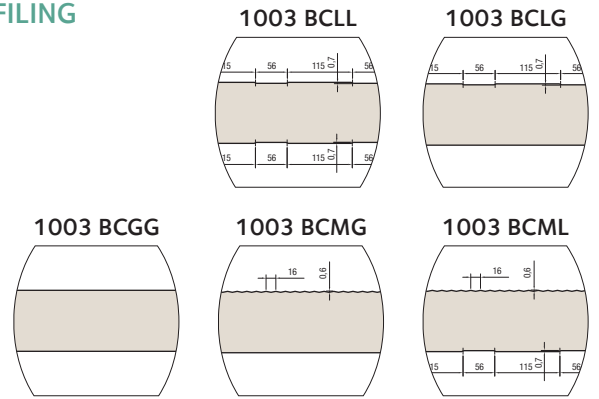

\* The combination of the GG profilations can be used as follows:  
 – ext. sheet with th. 0.63 mm  
 – int. sheet with th. 0.50 mm

## THE PANEL STRUCTURE

External and internal facing is made of ZN or ZM steel with th. 0.40, 0.50, 0.63 mm according to EN 10 147.

## TOLERANCE

according to EN 14509

## INSULATION CORE

Hardened PIR foam

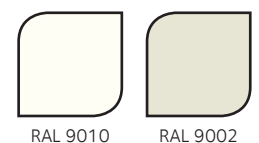

Interior (Hairplus 25):