

PIR FACADE PANEL

(invisible fixation)

2000/2003 BI

(Austrian production)

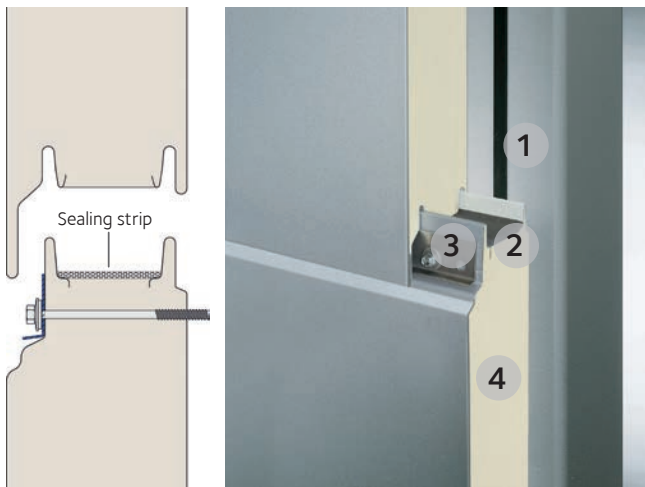

- 1 Sealing tape
- 2 Sealing strip
- 3 Fixation clip for invisible fixing
- 4 Hardened foam (CFC-free)

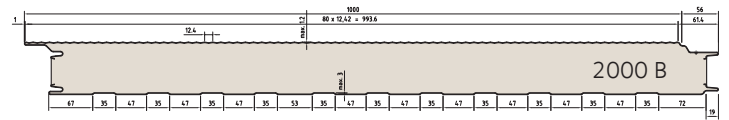

PROFILING

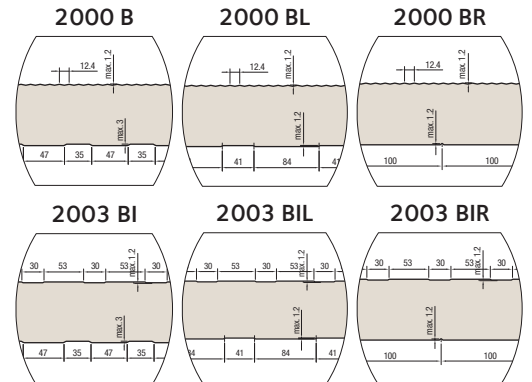

Panel thc. mm	2000/2003	
	U value according to EN 14509 W/m ² K	Panel weight kg/m ²
60	0,429	12,9
80	0,290	13,7
100	0,227	14,6
120	0,188	15,4
140	0,161	16,3

for standard sheet thickness 0.63/0.5 mm

2000/2003		
1000 mm, min. 0,50/0,40 mm		
Fire resistance (wall) according to EN 13501-2 EN 1364-1 ČSN EN 73 0810	EI 15 DP3 (i→o)	
Panel thc.	vert.	horiz.
≥ 100 mm	consultation necessary	
Reaction to fire according to EN 13501-1 B-s2,d0		



THE PANEL STRUCTURE

External and internal facing is made of ZN or ZM steel with th. 0.40, 0.50, 0.63 mm according to EN 10 147.

INSULATION CORE

Hardened PIR foam

TOLERANCE

according to EN 14509

Standard colors:

Exterior (Hairplus 25):

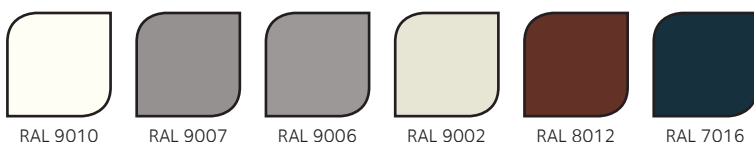

Other colors available on request

Interior (Interieur 12):

